

Very simple wiring diagram in a 8 room house (All lights On. All lights Off)

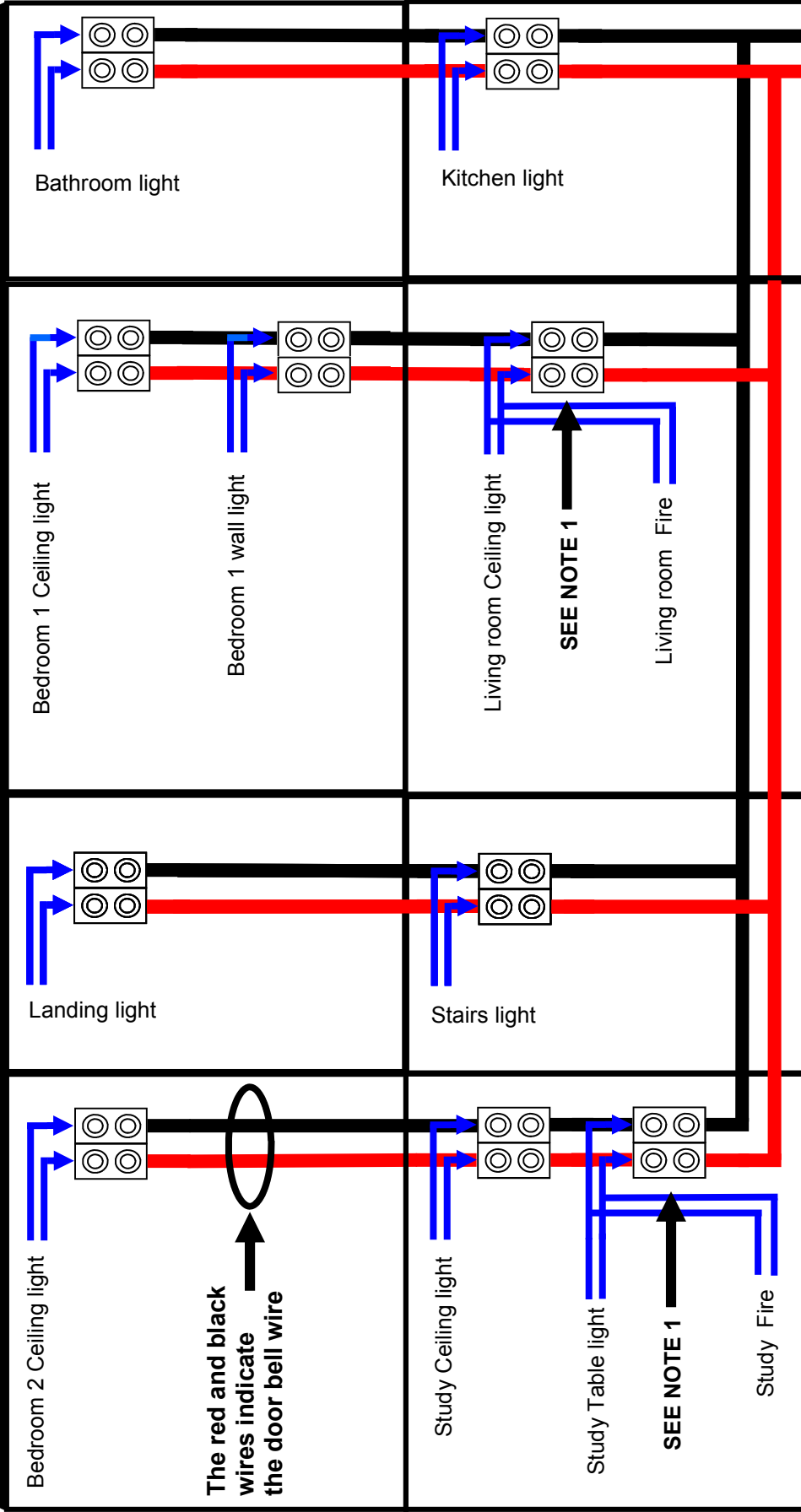

The red and black wires indicate the door bell wire

SEE NOTE 1

SEE NOTE 1

This diagram shows a very simple dolls house wiring plan using door bell wire and small electrical screw terminal blocks to make the connection. The Terminal blocks can be screwed to the back of the house.

When the power supply is turned on all the lights in the house will come on.

The wires shown in blue are the wires coming from an actual light fitting. You will notice that in the living room and the study both the fire, and the ceiling/table light use the same terminal block. This may work with other light fittings in the same, or adjoining rooms.

If the wires from the light fitting are long enough, you can then save using a terminal block.

This diagram could be scaled up for many more rooms.

NOTE 1 This terminal block would have two sets of light fitting wires screwed into it.

Power supply
(transformer)
240v input
12v DC output